

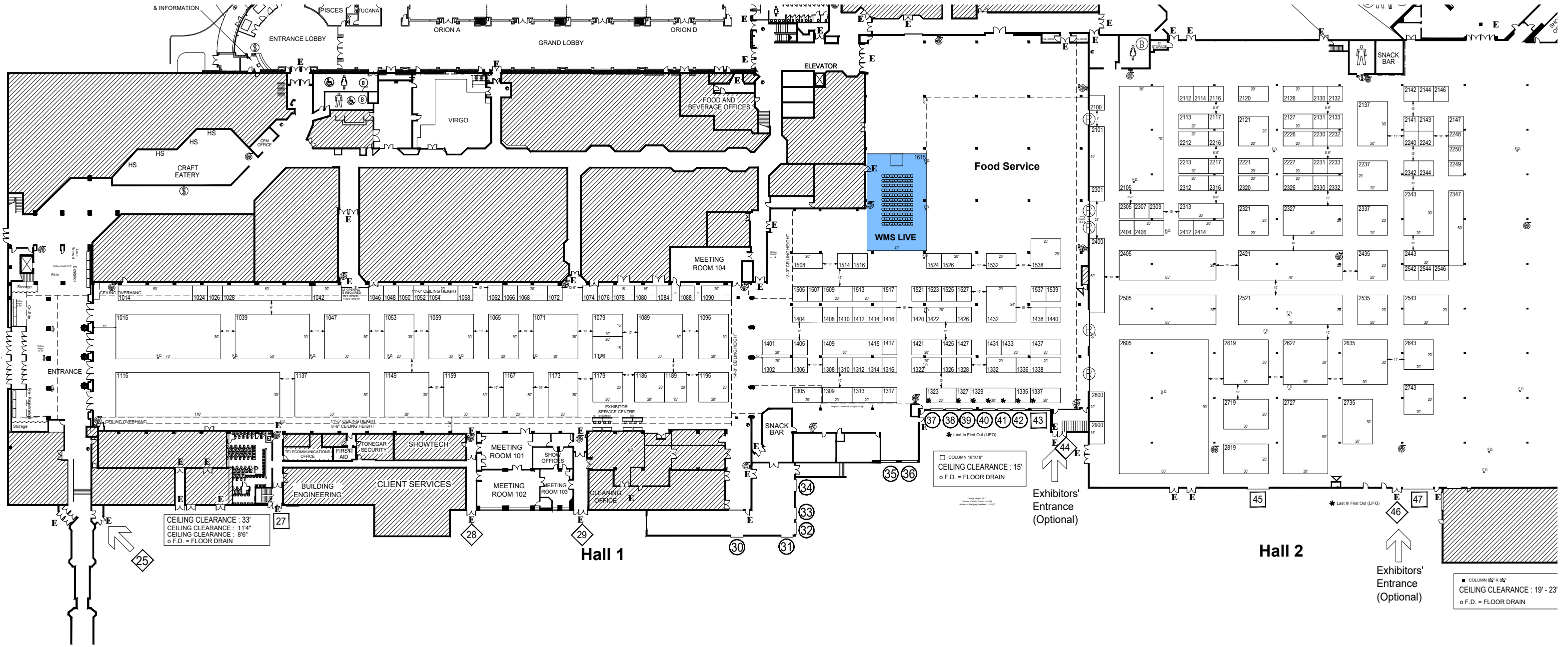

Woodworking Machinery & Supply Conference and Expo



COPYRIGHT © 2010 Global Experience Specialists.

All Rights Reserved. No part of this publication may be reproduced, stored in any retrieval system, or transmitted in any form or by any means - electronic, mechanical, photocopying, recording, or otherwise - without the express written consent of Global Experience Specialists

Every effort has been made to insure the accuracy of all information contained on this floor plan. However, no warranties, either expressed or implied, are made with respect to this floor plan. If the location of building columns, utilities, or other architectural components of the facility is a consideration in the construction or usage of an exhibit, it is the sole responsibility of the exhibitor to physically inspect the facility to verify all dimensions and locations.



November 4-6, 2021
International Centre, Toronto
Exhibit Halls 1 & 2

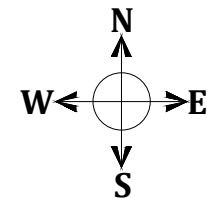

Confidential Property Of
Global Experience Specialists
File: WMS21 Feb 19 20.dwg
Layout: Ledger Dims
Plotted: February 19, 2020, 12:12:38 PM
By: Pirbhai, Nasera